

Premiere - Assembly Instruction

MERRYFAIR®

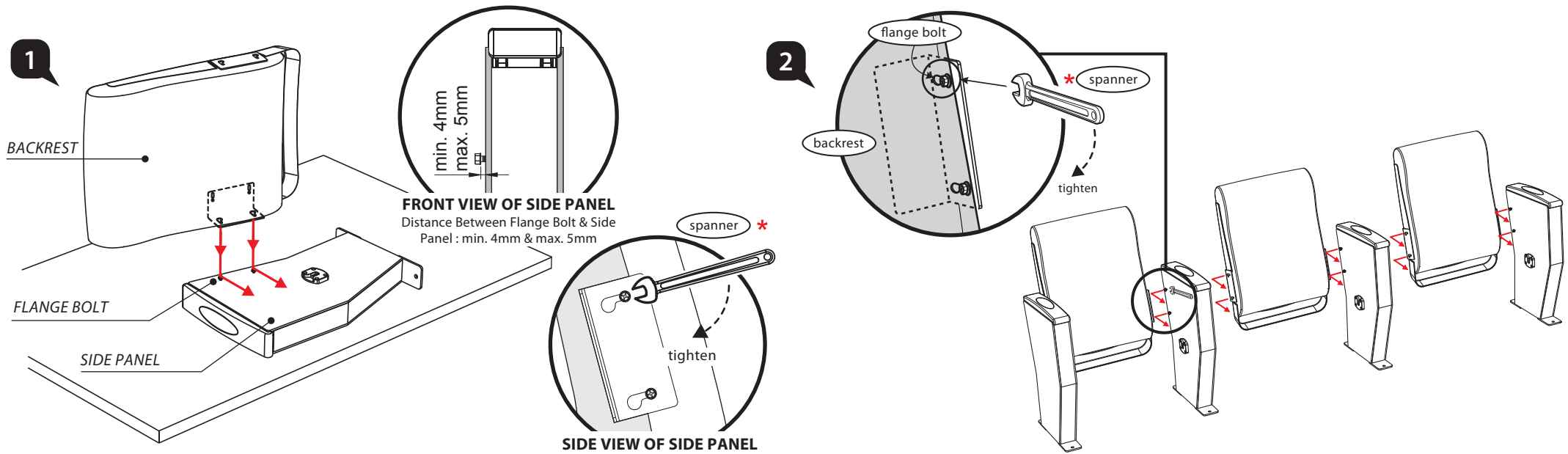

- 1a** - For installing the 1st chair, you're recommended to put side panel in **horizontal** way.
1b - Slot the backrest into the Flange Bolt which is prefix on the side panel, then slide the backrest into the direction as shown above. Tighten the flange bolt by using *spanner.

- 2a** - Return the chair into **Vertical** position.
2b - Slot another side panel into the chair and tighten the flange bolt by using *spanner.
2c - Repeat step **1b** and **2b**.

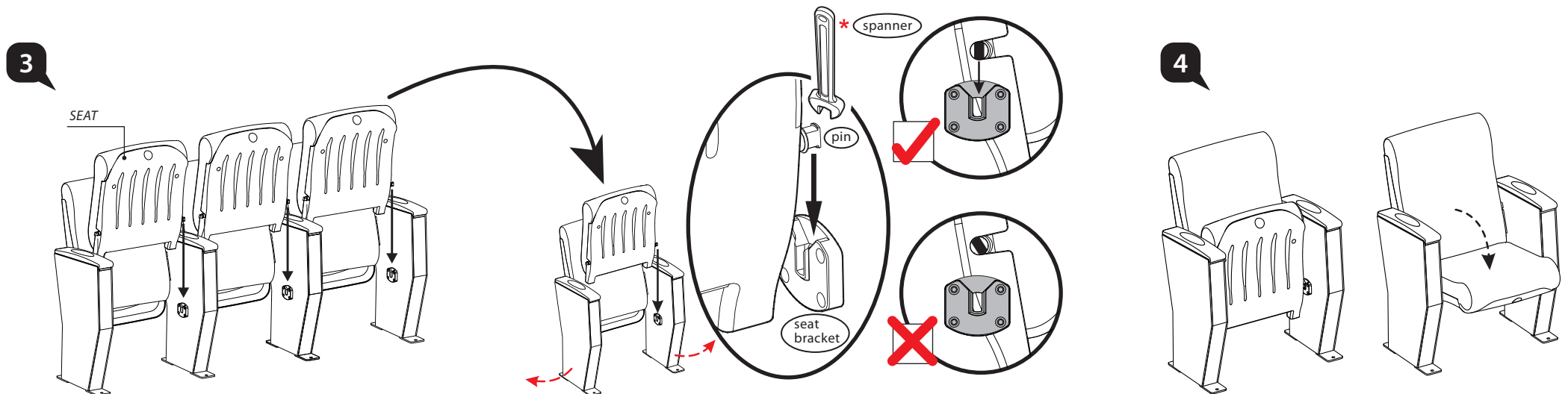

- 3a** - Slot the seat into the seat bracket at side panel.

NOTE: You have to slightly widen-up the both side panels to slot the seat into the bracket. You may use *spanner to help you to adjust the pin so that it's parallel to the seat bracket.

Completed View

*** NOT INCLUDED**

Premiere – Floor mounting Instruction

MERRYFAIR®

- 1 Put the linked chair at desired position.
- 2 Use the linked chair as a template, use power drills to drill the holes on the floor. (Diameter of the holes depends on the screw that use to fix to the floor)
- 3 Fix the link chair to the floor by using:-

Proposed to use:

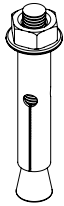

or



concrete floor:
* 5/16" Expansion Bolt

wooden floor:
* Hexagon Coach Screw

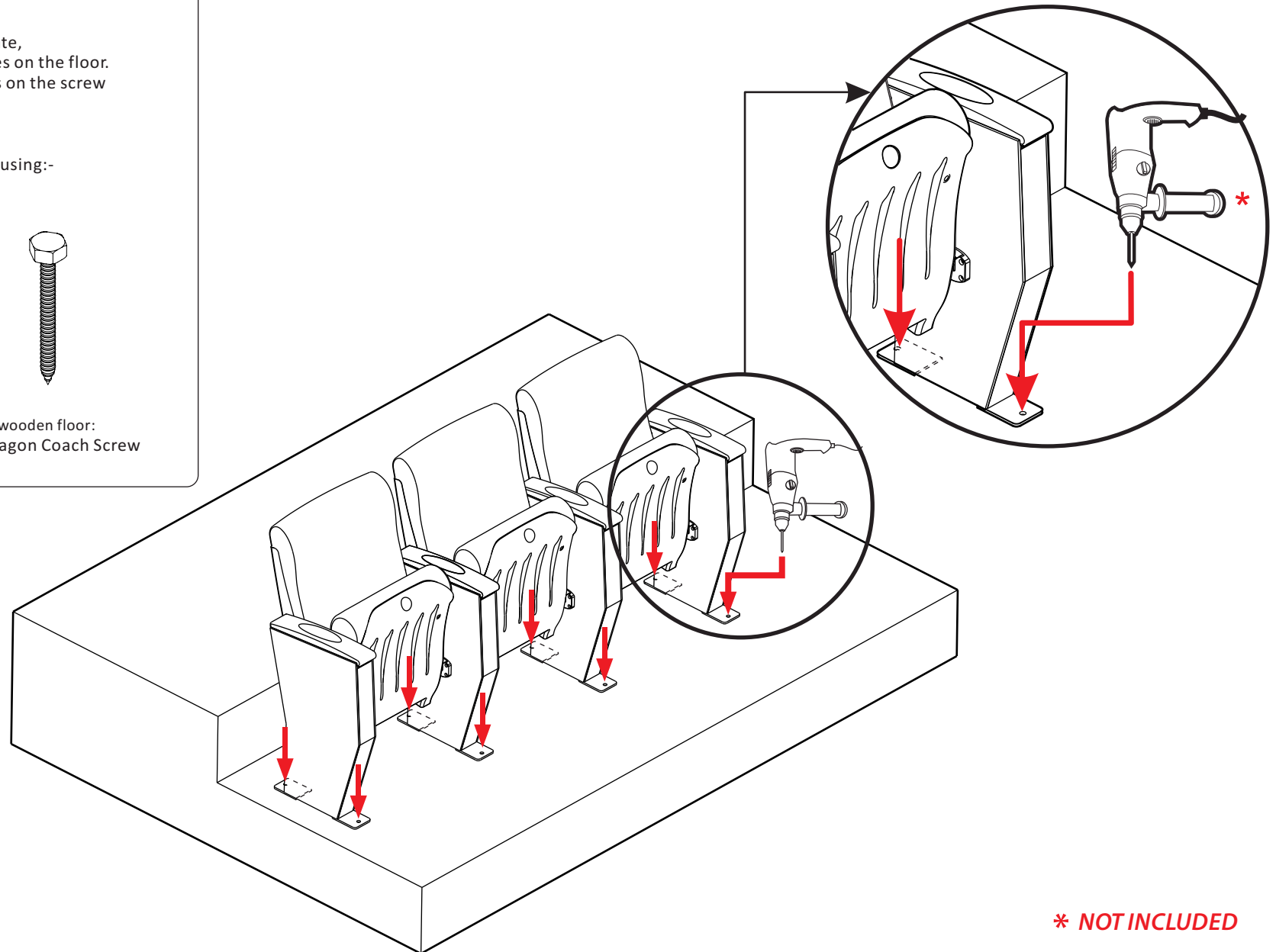

* NOT INCLUDED

Premiere Aisle Light - Assembly Instruction

MERRYFAIR®

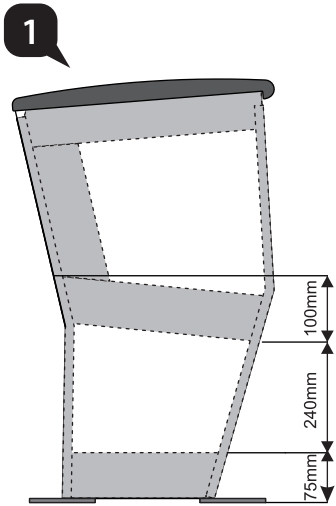

- Put the aisle light at desired position, avoid the metal frame (shaded) inside the fabric panel.

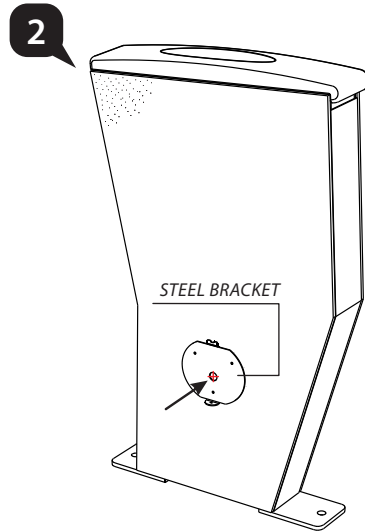

- Use the steel bracket to mark the wiring hole at the fabric panel & drill through it.

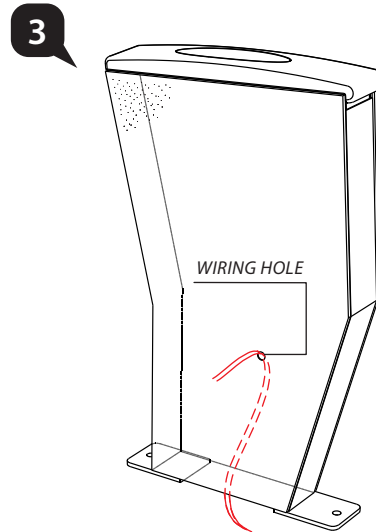

- Insert the main wire from floor to the wiring hole on fabric panel.

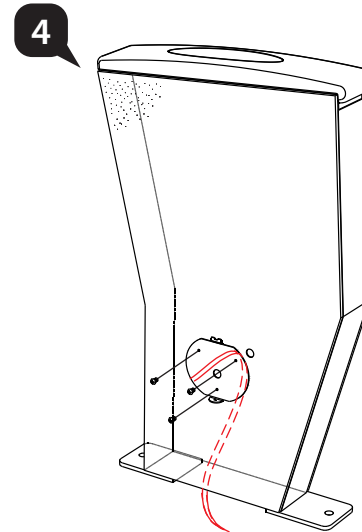

- Insert the main wire to the steel bracket. Fix the steel bracket on the fabric panel by using CSK Self Tapping Screw #6 x 1/2".

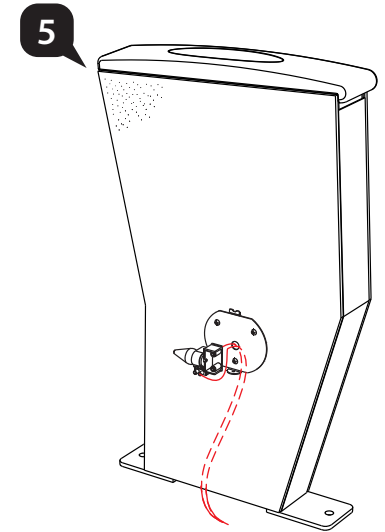

- Connect the wire to *light fixture.
* NOT INCLUDED

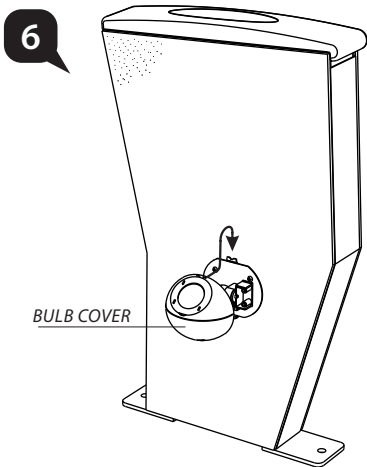

- Slot the bulb cover to the steel bracket.

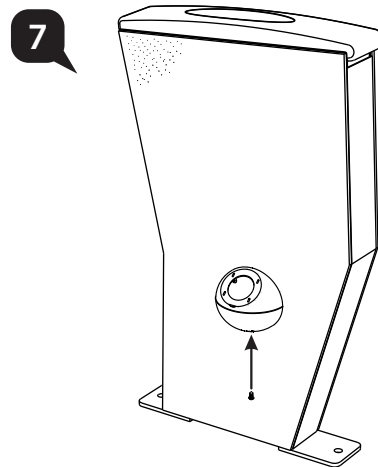

- Fix the bulb cover to the steel bracket from bottom by using CSK Self Tapping Screw #6 x 1/2".

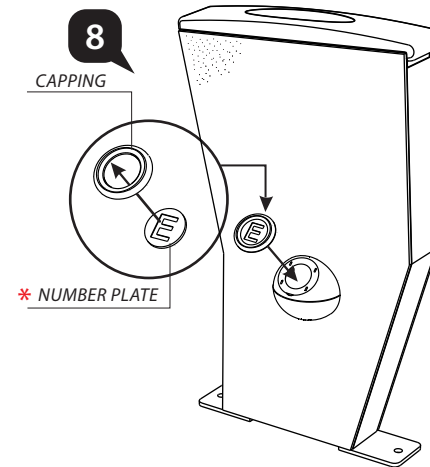

- Insert the *number plate to the Capping, then insert the assembled parts into the bulb cover.

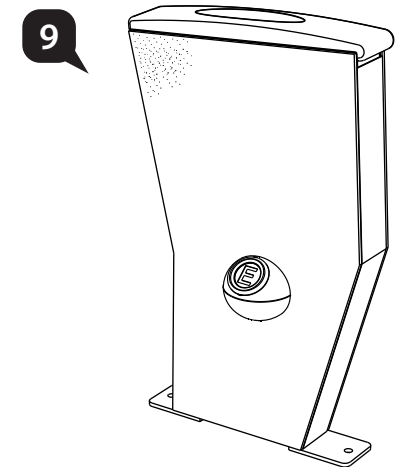

Completed View