

Assembly Instruction

MERRYFAIR®

1

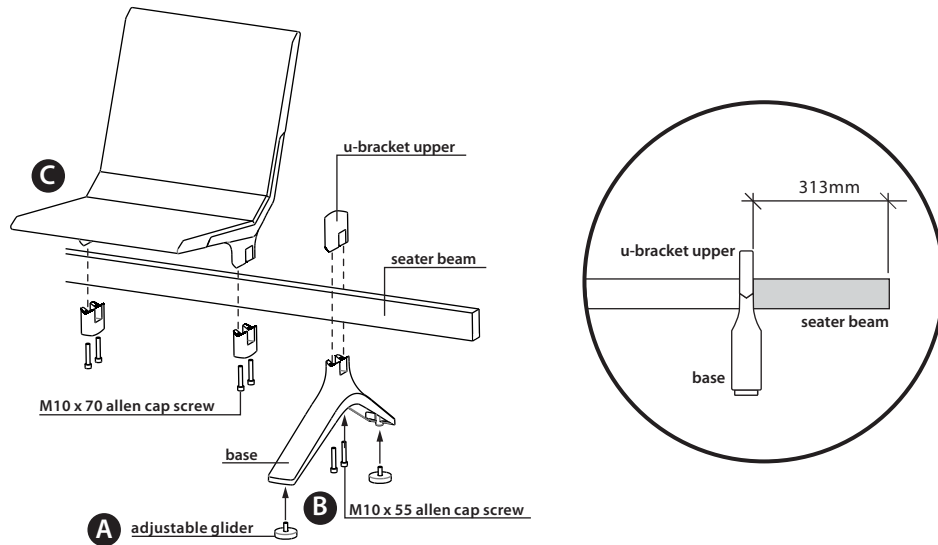

- A** Insert adjustable glider into base.
- B** Slot u-bracket upper (or armrest) & base into seater beam (following measurement given) and tighten with M10 x 55 allen cap screw.
- C** Slot seat pad & u-bracket lower into seater beam (following measurement given) and tighten with M10 x 70 allen cap screw.

2

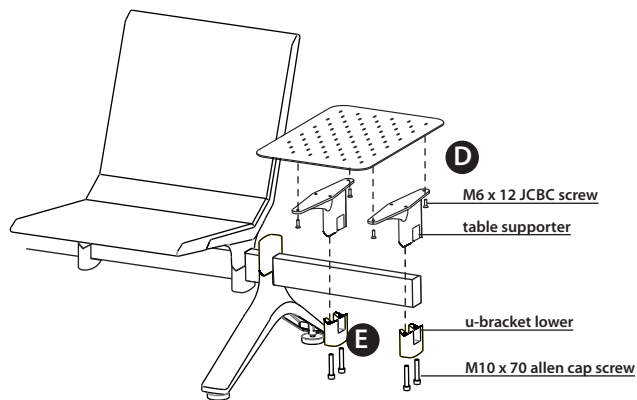

- D** Fix table supporter to side table with M6 x 12 JCBC screw.
- E** Slot side table + table supporter and u-bracket lower into side table beam and tighten with M10 x 70 allen cap screw.

Flite

Models: 557 B1 / B2 / B3 / B4 / B6 A00 J with TS4 SIDE TABLE

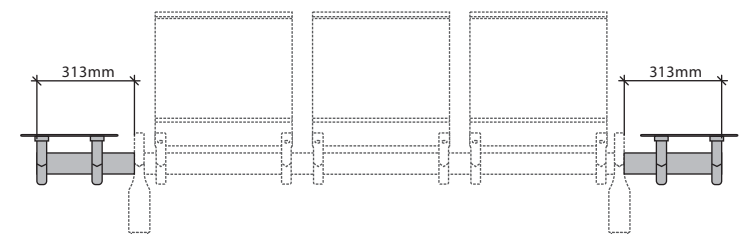
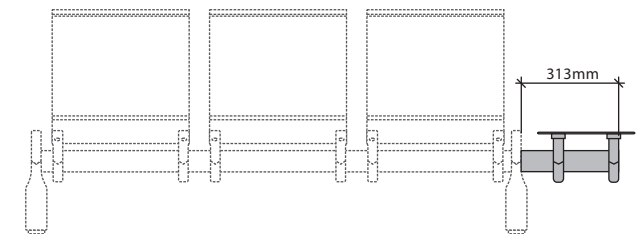
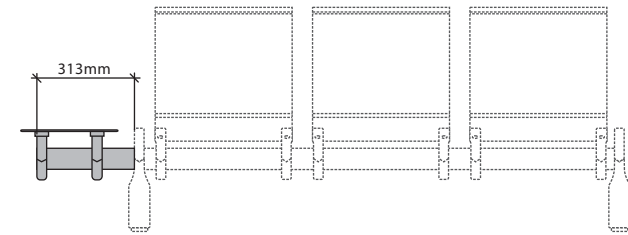

Assembly Instruction

MERRYFAIR®

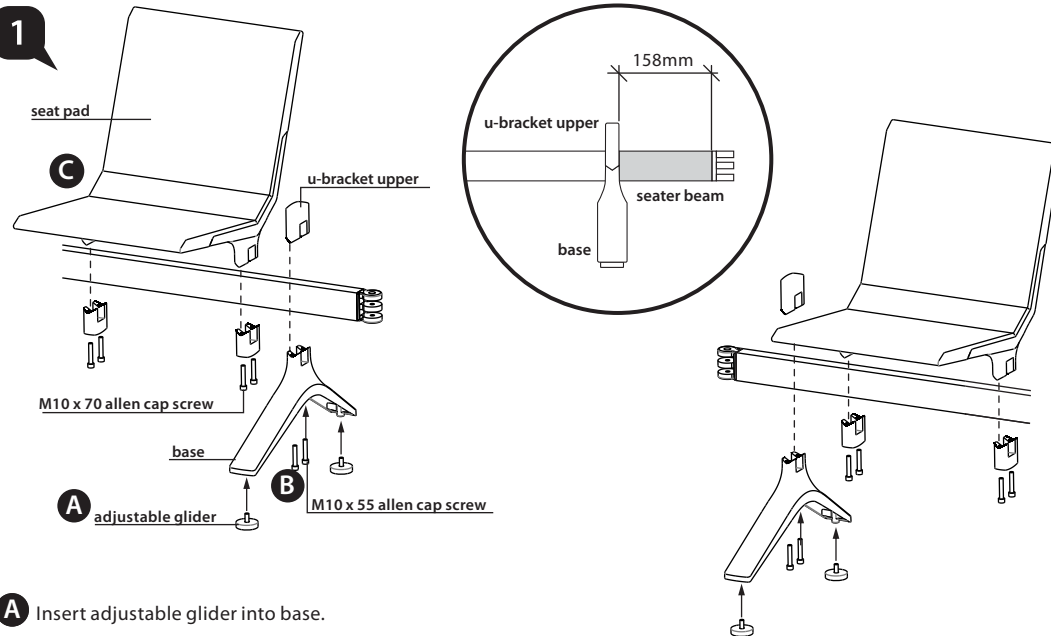

- A** Insert adjustable glider into base.
- B** Slot u-bracket upper (or armrest) & base (following measurement given) into seater beam and tighten with M10 x 55 allen cap screw.
- C** Slot seat pad & u-bracket lower into seater beam (following measurement given) and tighten with M10 x 70 allen cap screw.

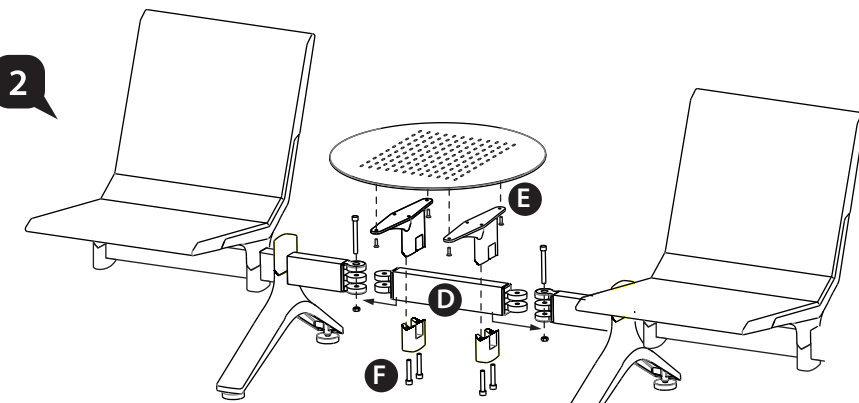

- D** Insert corner table beam into 2 individual seater beam and tighten with M10 x 75 csk allen cap screw & M10 hexagon nut.
- E** Fix table supporter to round turn table with M6 x 12 JCBC screw.
- F** Slot round turn table + table supporter and u-bracket lower into corner table beam and tighten with M10 x 70 allen cap screw.

Flite

Models: 557 B1 / B2 / B3 / B4 / B6 A00 J with TT2 TURN TABLE

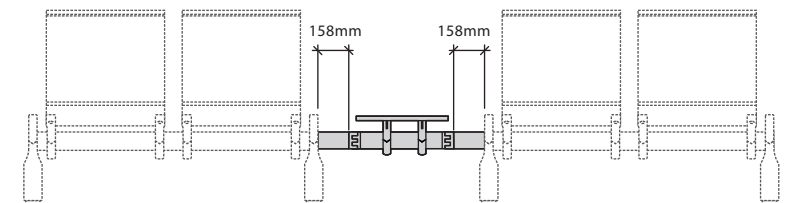

Assembly Instruction

MERRYFAIR®

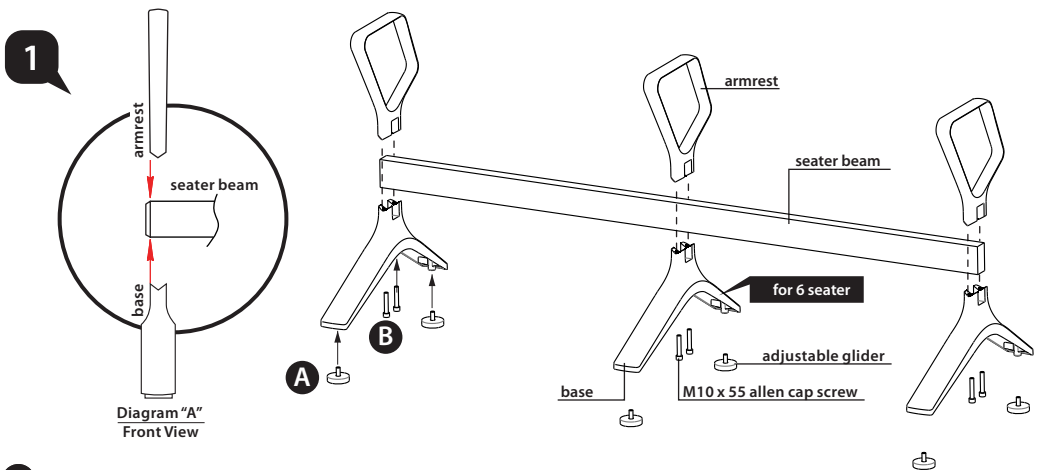

- A** Insert adjustable glider into base.
- B** Slot armrest & base into the seater beam and tighten with M10 X 55 allen cap screw.

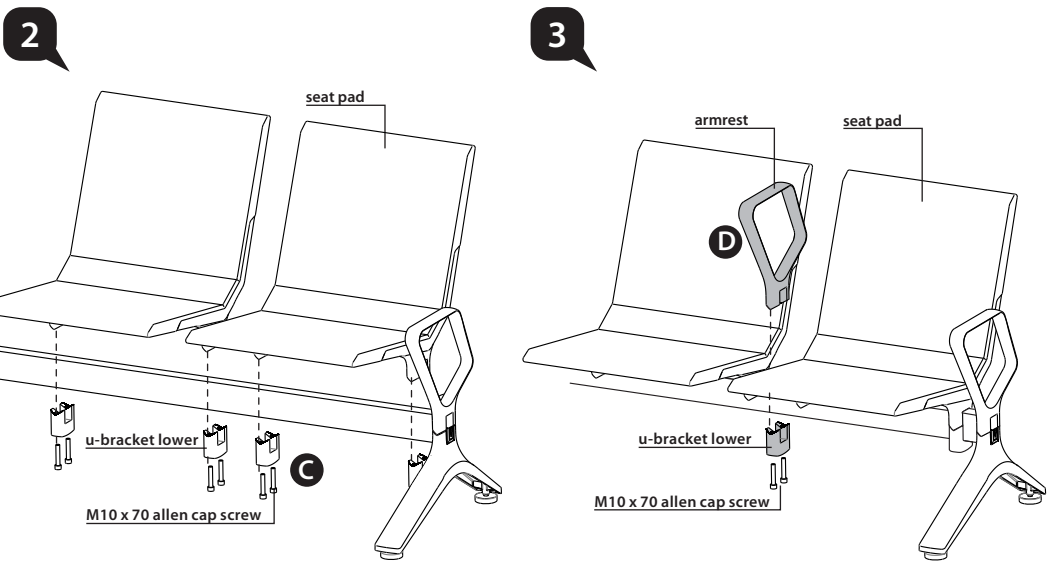

- C** Slot seat pad and u-bracket lower into seater beam (following measurement given) and tighten with M10 X 70 allen cap screw.
- D** Slot armrest and u-bracket lower into the seater beam (adjust the armrest so that it is at the center of 2 seat shell) and tighten with M10 X 70 allen cap screw.

Flite

Models: 557 B1 / B2 / B3 / B4 / B6 A70 J

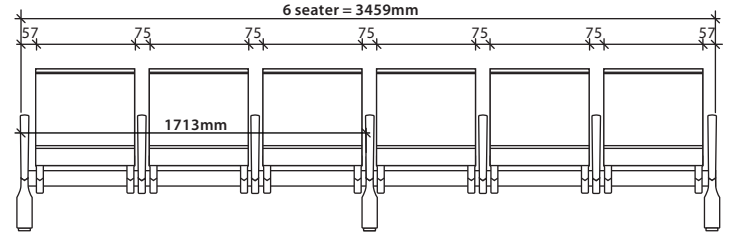
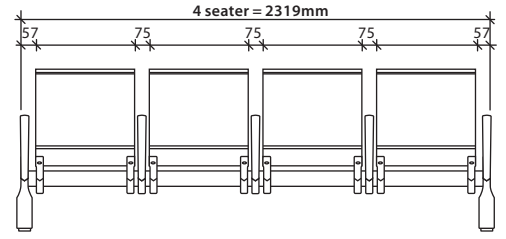
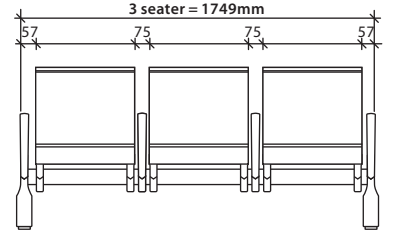
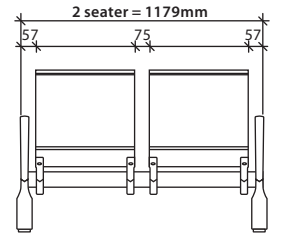

Assembly Instruction

MERRYFAIR®

1

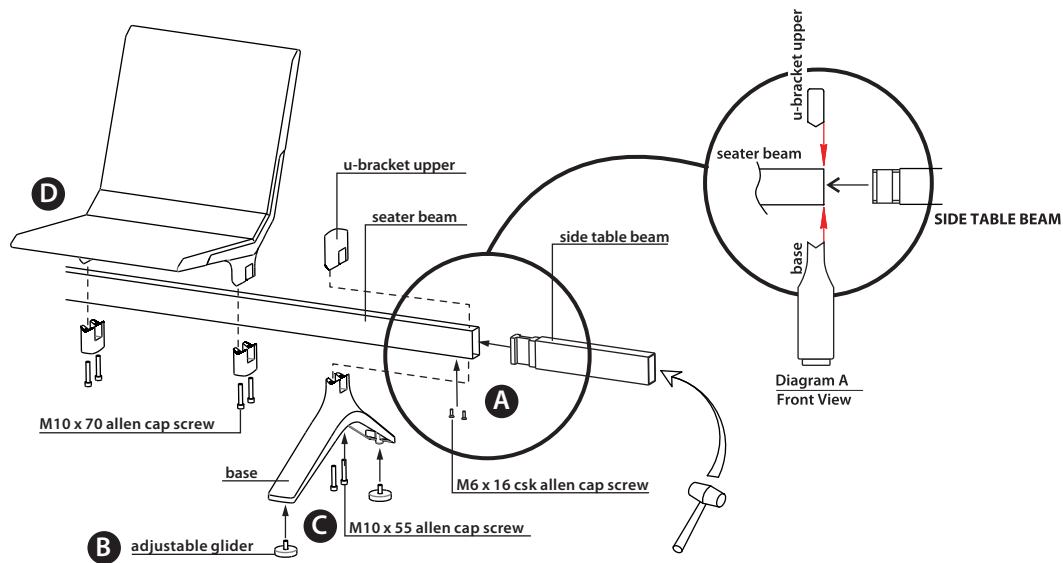

- A** Insert side table beam into one or both end side of seater beam by using rubber hammer and tighten with M6 x 16 CSK allen cap screw.
- B** Insert adjustable glider into base.
- C** Slot u-bracket upper (or armrest) & base into seater beam and tighten with M10 x 55 allen cap screw.
- D** Slot seat pad & u-bracket lower into seater beam (following measurement given) and tighten with M10 x 70 allen cap screw.

2

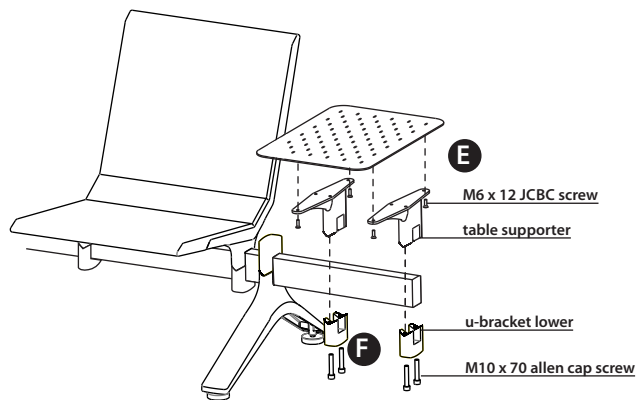

- E** Fix table supporter to side table with M6 x 12 JCBC screw.
- F** Slot side table + table supporter and u-bracket lower into side table beam and tighten with M10 x 70 allen cap screw.

Flite

Models: 557 B1 / B2 / B3 / B4 / B6 A00 J
- add in TS4 side table as an accessory.

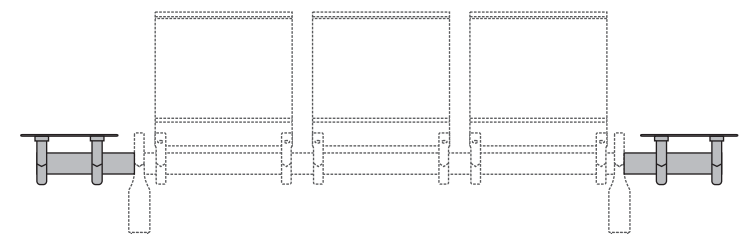
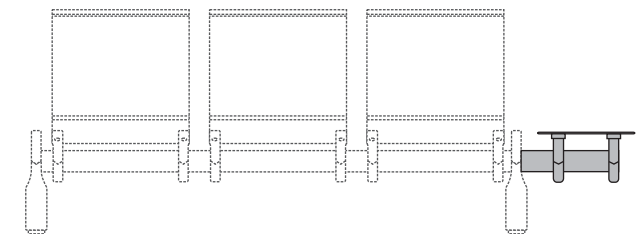
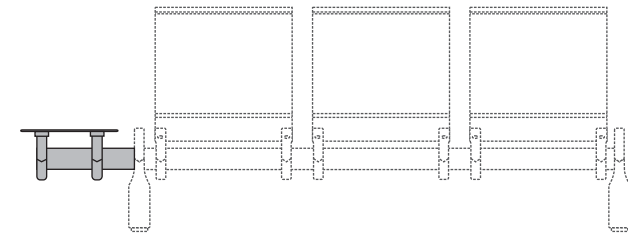

Assembly Instruction

MERRYFAIR®

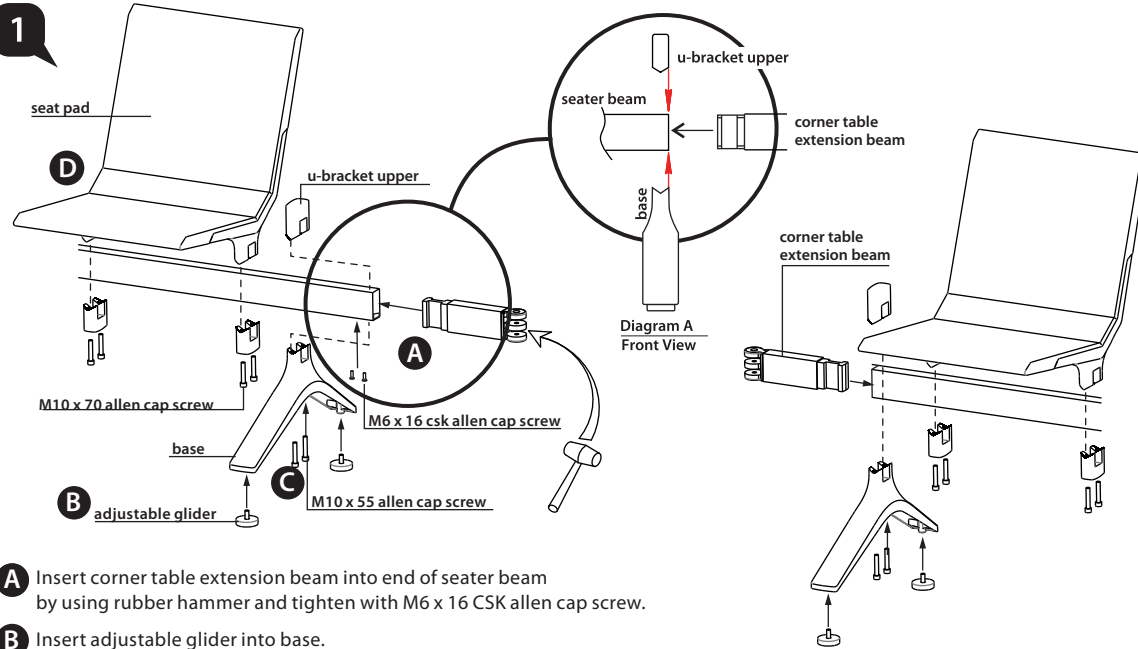

- A** Insert corner table extension beam into end of seater beam by using rubber hammer and tighten with M6 x 16 CSK allen cap screw.
- B** Insert adjustable glider into base.
- C** Slot u-bracket upper (or armrest) & base into seater beam and tighten with M10 x 55 allen cap screw.
- D** Slot seat pad & u-bracket lower into seater beam (following measurement given) and tighten with M10 x 70 allen cap screw.

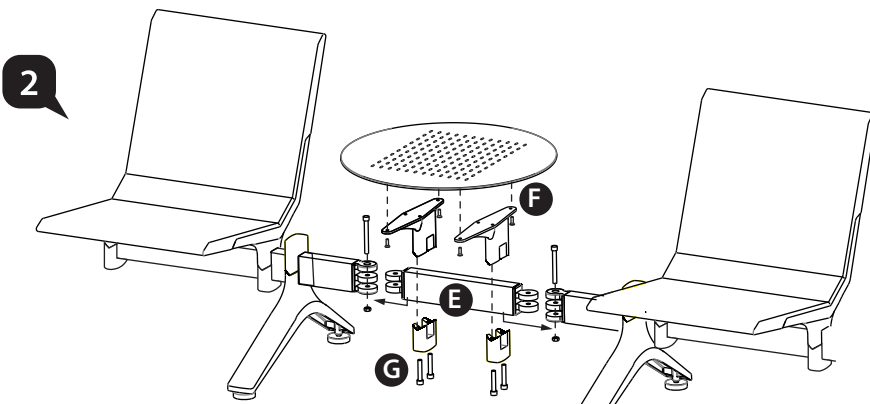

- E** Insert corner table beam into 2 individual seater beam and tighten with M10 x 75 csk allen cap screw & M10 hexagon nut.
- F** Fix table supporter to round turn table with M6 x 12 JCBC screw.
- G** Slot round turn table + table supporter and u-bracket lower into corner table beam and tighten with M10 x 70 allen cap screw.

Flite

Models: 557 B1 / B2 / B3 / B4 / B6 A00 J
- add in TT2 side table as an accessory.

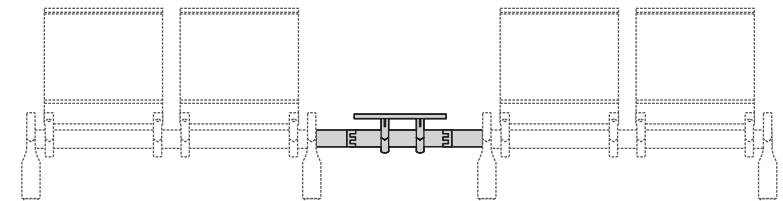

Assembly Instruction

MERRYFAIR®

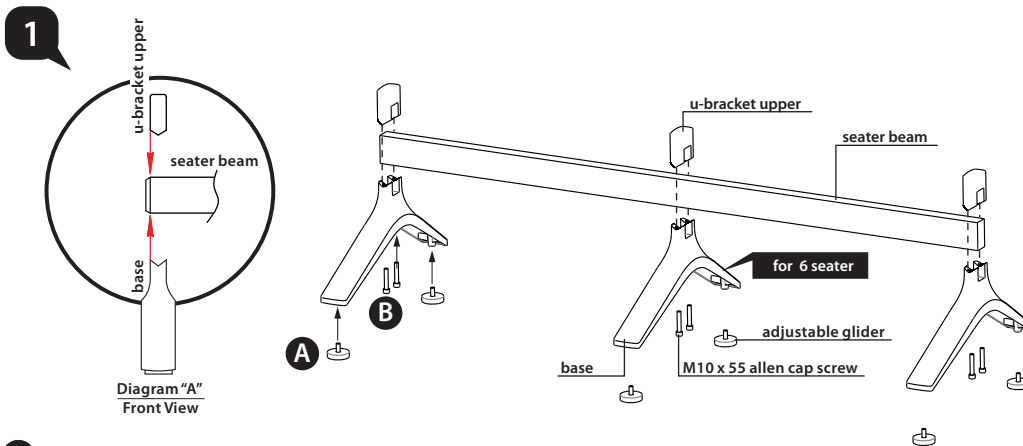

- A** Insert adjustable glider into base.
- B** Slot u-bracket upper & base into the seater beam and tighten with M10 X 55 allen cap screw.

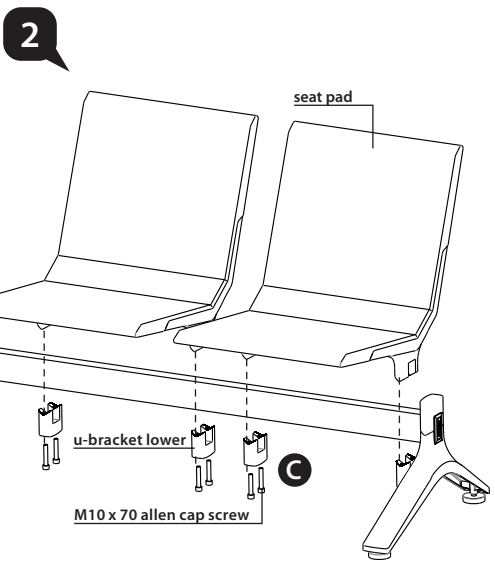

- C** Slot seat pad and u-bracket lower into seater beam (following measurement given) and tighten with M10 X 70 allen cap screw.

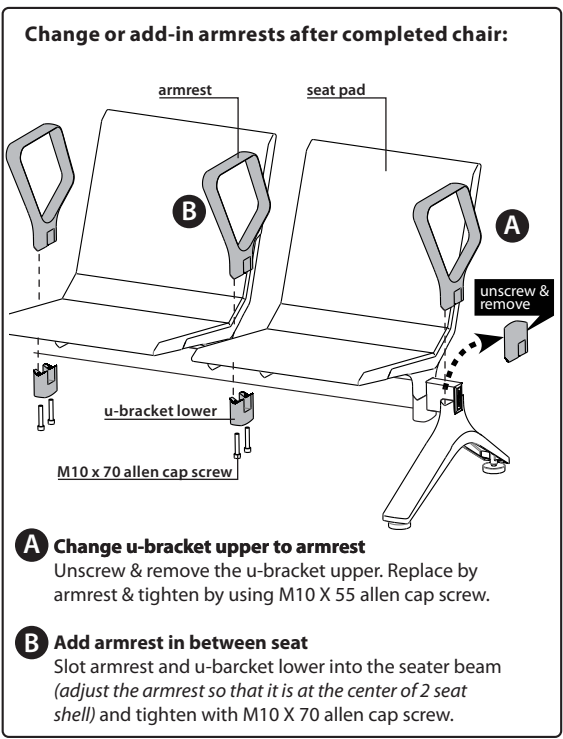

Flite

Models: 557 B1 / B2 / B3 / B4 / B6 A00 J

